

## MODEL : STV-203S [ Screw end Strainer ]

Connection : Screw BSPT, NPT



**VTV VALVE**, serving Multi-National end users in a wide range of applications in many industries including:

1. Air-Conditioning System
2. Hot Water Application
3. General Industries.

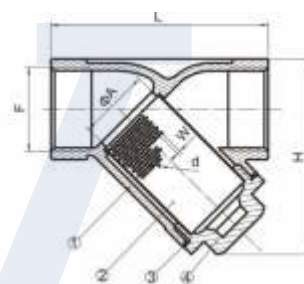
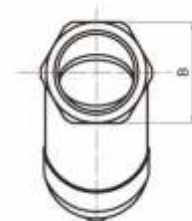
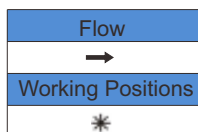

- ◆ **Suitable for :**
1. Water
  2. Steam
  3. Oil
  4. Gases
  5. Non-abrasive media

### ◆ FEATURES

1. 800PSI(PN40)
2. Investment Casting
3. PED97/23/PE (CE0035) Approved
4. Casting Approved AD2000-W0
5. Thread: ASME B1.20.1, BS21.DIN2999/259, ISO228-1, JIS B 0203, ISO7/1
6. Inspection Testing: DIN3230/3, EN12266

### ◆ MATERIAL LIST

ITEM	DESIGNATION	QTY	MATERIAL
1	BODY	1	CF8/CF8M
2	GASKET	1	PTFE
3	SCREEN	1	304/316
4	CAP	1	CF8/CF8M

### ◆ DIMENSIONS (mm)

SIZE	A	B	H	L	W	d
1/4"	15	26	58	65	2	1
3/8"	15	26	58	65	2	1
1/2"	15	26	58	65	2	1
3/4"	20	33	68	78.5	2	1
1"	25	41	88	89	2	1
1-1/4"	32	49	100	105	2	1
1-1/2"	40	56	108	120	2	1
2"	50	69	130	140	2	1

Specification is subject to change without prior notice